



Sage[®] Basic Dressing Packs

AAT, Classic & Premium Packs

Aaxis Pacific Aseptic Opening Technique

Non touch opening method ensures pack can be opened without compromising the sterile field

Aseptic transfer point permits tray to be moved without compromising sterility

Rigid squish pad area allows excess fluid to be removed from swabs and bobs and be retained in tray corners

Environmentally safe – incineration process converts pack to harmless gasses of oxygen and carbon dioxide

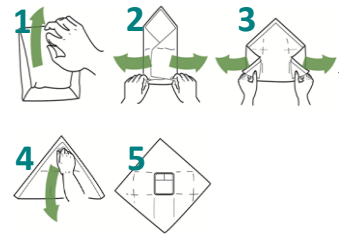

Non Touch Opening Method

PRODUCT CODE	PRODUCT DESCRIPTION	SKU (MOQ)	SKU/ Inner	SKU/ CTN
CLASSIC DRESSING PACKS				
11001071	Sage [®] Basic Dressing Pack #71 PP MT Sterile , Mini	140	N/A	140
11001074	Sage [®] Basic Dressing Pack #74 PP MT Sterile , Mini	140	N/A	140
11001076	Sage [®] Basic Dressing Pack #76 PP MT Sterile , Mini	140	N/A	140
AAT – CLASSIC DRESSING PACKS				
11001001	Sage [®] Basic Dressing Pack #1 TP AAT Standard, Sterile	220	20	220
11001003	Sage [®] Basic Dressing Pack #3 TP AAT Standard, Sterile	220	20	220
11001008	Sage [®] Basic Dressing Pack #8 TP AAT Standard, Sterile	220	20	220
11001010	Sage [®] Basic Dressing Pack #10 PP AAT Standard, Sterile	140	N/A	140
11001012	Sage [®] Basic Dressing Pack #12 Inverted PP AAT Standard, Sterile	140	N/A	140
11001014	Sage [®] Basic Dressing Pack #14 TP AAT Standard, Sterile	140	20	140
11001016	Sage [®] Basic Dressing Pack #16 Inverted TP AAT Standard, Sterile	140	20	140
11001046	Sage [®] Basic Dressing Pack #46 TP AAT Standard, Sterile	200	20	200
11001075	Sage [®] Basic Dressing Pack #6 TP AAT Standard, Sterile	220	20	220
AAT – PREMIUM DRESSING PACKS				
11001044	Sage [®] Basic Dressing Pack #44 TP AAT Premium, Sterile	160	20	160
11001068	Sage [®] Basic Dressing Pack #68 PP AAT Premium, Sterile	160	20	160



Sage[®] Basic Dressing Packs

Classic

Basic Dressing Pack #71

PRODUCT CODE: 11001071

1 x Small Tray

8 x Cotton Ball 0.3g

5 x Non Woven Swabs 7.5 x 7.5cm 4 Ply

2 x Forceps Green

1 x Forceps Yellow

1 x Towel Blue Guard 40 x 40cm

1 x White Plastic Field 50 x 50cm

Basic Dressing Pack #76

PRODUCT CODE: 11001076

1 x Aseptic Tray

5 x Non-Woven Bobs .3gm

2 x Non-Woven Swabs 7.5 x 7.5cm 4-Ply

2 x Forceps Green

1 x Forceps Yellow

1 x Towel Blue Guard 40 x 40cm

1 x White Plastic Field 50 x 50cm

Basic Dressing Pack #74

PRODUCT CODE: 11001074

1 x Small Tray 125 x 105 x 25mm

6 x Gauze Swabs 7.5 x 7.5cm 8-Ply

2 x Forceps Green

1 x Forceps Yellow

1 x Towel Blue Polylined 42 x 42cm

1 x Field White Plastic 47.5 x 47.5cm



Sage[®] Basic Dressing Packs

AAT – Classic

Basic Dressing Pack #1

PRODUCT CODE: 11001001

1 x Aseptic Tray
5 x Cotton Balls
2 x Gauze Swabs 7.5 x 7.5cm 8-Ply
2 x Forceps Green
1 x Forceps Yellow
1 x Towel 2-Ply Paper 40 x 40cm
1 x Field White Plastic 47.5 x 47.5cm

Basic Dressing Pack #3

PRODUCT CODE: 11001003

1 x Aseptic Tray
5 x Gauze Swabs 7.5 x 7.5cm 8-Ply
2 x Forceps Green
1 x Forceps Yellow
1 x Towel 2-Ply Paper 40 x 40cm
1 x Field White Plastic 47.5 x 47.5cm

Basic Dressing Pack #8

PRODUCT CODE: 11001008

1 x Aseptic Tray
5 x Non-Woven Bobs .3gm
2 x Non-Woven Swabs 7.5 x 7.5cm 4-Ply
2 x Forceps Green
1 x Forceps Yellow
1 x Towel 2-Ply Paper 38 x 40cm
1 x Field White Plastic 47.5 x 47.5cm

Basic Dressing Pack #10

PRODUCT CODE: 11001010

1 x Small Tray 125 x 105 x 25mm
5 x Cotton Balls
2 x Gauze Swabs 7.5 x 7.5cm 8-Ply
3 x Forceps Green
1 x Towel 2-Ply Paper 42 x 40cm
1 x Field White Plastic 47.5 x 47.5cm

Basic Dressing Pack #12

PRODUCT CODE: 11001012

1 x Small Tray 125 x 105 x 25mm
6 x Non-Woven Swabs 7.5 x 7.5cm 4-Ply
3 x Forceps Green
1 x Towel 2-Ply Paper 42 x 40cm
1 x Field White Plastic 47.5 x 47.5cm

Basic Dressing Pack #14

PRODUCT CODE: 11001014

1 x Standard Tray 145 x 130 x 18mm
6 x Non-Woven Swabs 7.5 x 7.5cm 4-Ply
2 x Forceps Green
1 x Forceps Yellow
1 x Towel 2-Ply Paper 42 x 40cm
1 x Field White Plastic 50 x 50cm



Sage[®] Dressing Packs

AAT – Classic

Basic Dressing Pack #16

PRODUCT CODE: 11001016

1 x Standard Tray 145 x 130 x 18mm

6 x Non-Woven Swabs 7.5cm x 7.5 cm 4-Ply

2 x Forceps Green

1 x Forceps Yellow

1 x Towel Blue Polylined 42 x 40cm

1 x Field White Plastic 50 cm x 50 cm

Basic Dressing Pack #6

PRODUCT CODE: 11001075

1 x Aseptic Tray

5 x Non Woven Swabs 7.5 x 7.5cm

2 x Forceps Green

1 x Forceps Yellow

1 x Towel Paper 2-Ply

1 x White Plastic Field

Basic Dressing Pack #46

PRODUCT CODE: 11001046

1 x Aseptic Tray

5 x Non-Woven Bobs .3gm

2 x Non-Woven Swabs 7.5 x 7.5cm 4-Ply

2 x Forceps Green

1 x Forceps Yellow

1 x Towel Blue Polylined 42 x 42cm

1 x Field White Plastic 50 x 50cm



Sage[®] Basic Dressing Packs

AAT – Premium

Basic Dressing Pack #44

PRODUCT CODE: 11001044

1 x Premium Tray 140 x 130 x 20mm

6 x Non-Woven Swabs 7.5 x 7.5cm 4 Ply

2 x Forceps Green

1 x Forceps Yellow

1 x Towel 2-Ply Paper 40 x 40cm

1 x Field White Plastic 50 x 50cm

Basic Dressing Pack #68

PRODUCT CODE: 11001068

1 x Premium Tray 140 x 130 x 20mm

5 x Non Woven Bobs

2 x Non Woven Swabs 7.5 x 7.5cm 4 Ply

2 x Forceps Green

1 x Forceps Yellow

1 x Towel Paper 42 x 40cm

1 x White Plastic Field 50 x 50cm