

INSTRUCTIONS FOR USE



Highly
Absorbent



High Fluid
Retention



Sideways
Swelling

IMPERVIA[®] Neosorb Superabsorbent Dressing

Impervia Neosorb Superabsorbent dressing is a thin, soft and flexible wound dressing comprised of an outer blue water resistant layer, inner core of superabsorbent polymer, and a soft, white permeable wound/skin contact layer of non-woven fabric.

Impervia Neosorb Superabsorbent dressing readily absorbs and 'binds' large amounts of wound exudate, and bacteria contained in it, into the dressing, reducing:

- Risk of maceration
- Impact from Matrix metalloproteinases (MMP) imbalance
- Number of dressing changes required
- Bacterial numbers that may impair the wound healing process

Impervia Neosorb Superabsorbent dressing fluid absorption capacity makes it suitable for the management of wounds with heavy to very heavy levels of exudate. The outer backing of Impervia Neosorb Superabsorbent dressing is moisture resistant, ensuring the protection of patient clothing and linen.

Each dressing is individually packed, ready for use, and sterilised by ethylene oxide. Impervia Neosorb Superabsorbent dressings are sterile unless the package is opened or damaged, are single use only and should not be re-sterilised.

INDICATIONS

Impervia Neosorb Superabsorbent dressings are indicated for use in the management of all types of wounds with heavy to very heavy exudate production, such as:

- Partial thickness burns
- Arterial ulcers
- Pressure injuries
- Fistulae
- Venous leg ulcers
- Post-operative and laparotomy wounds healing by secondary intent
- Diabetic ulcers

Impervia Neosorb Superabsorbent dressing can be used as a primary dressing or, with other wound contact layers, as a secondary dressing where increased absorption capacity will reduce the need for dressing changes and the possible disturbance of new tissue.

CONTRADICTIONS

- Should not be used if allergies to any of its components is known.
- Should not be inserted into cavities or deep wounds, as swelling of the dressing may cause damage to surrounding tissue.
- Should not be used on wounds with light exudate levels, as it may produce a wound environment too dry to support healing.

GENERAL INFORMATION

- Impervia Neosorb Superabsorbent dressing is ideal for use with prescribed compression treatment for Venous Leg Ulcers due to its very low profile
- If infection is present, a primary wound cleansing dressing e.g. Osmonate[®] Calcium Alginate dressing or rope, or an antimicrobial layer, such as Zorflex[®] Wound Contact Layer should be used in combination with Osmocel Si Silicone Hydroporous Foam. The clinician in-charge is responsible for determining if necessary.

OPTIONS

| REORDER | SIZE | PCS/UNIT |
|---------|-------------|----------|
| NWC040 | 10cm x 10cm | 20 |
| NWC041 | 15cm x 15cm | 20 |
| NWC046 | 10cm x 20cm | 20 |
| NWC042 | 15cm x 20cm | 20 |
| NWC043 | 20cm x 20cm | 20 |
| NWC044 | 20cm x 30cm | 20 |
| NWC045 | 20cm x 45cm | 5 |
| NWC047 | 30cm x 45cm | 5 |

RECOMMEND

UP TO
7
DAYS

EXUDATE

UP TO
HEAVY

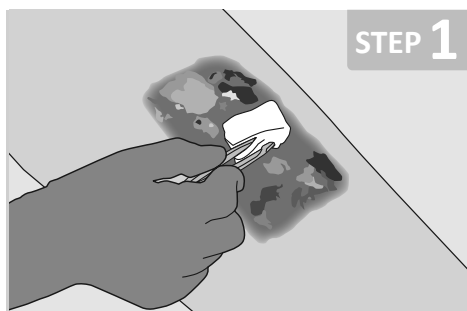

STEP 1

Cleanse wound thoroughly, using local protocols. The skin surrounding the wound should be clean and dry.



STEP 2

Dressing size is dependent on the wound surface area – the dressing edge should extend 2 - 3cms beyond the wound margin.



STEP 3

Open the sterile packaging and remove the dressing. Apply the Impervia Neosorb Superabsorbent dressing white side to the wound or skin surface.

METHODS OF FIXATION

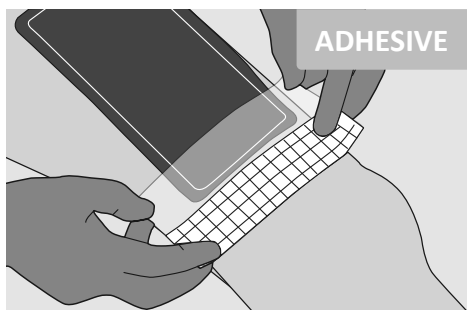

ADHESIVE

Fix the dressing in place with an appropriate retention product, e.g. AsGuard® Clear film or SofSecure® Silicone Tape.

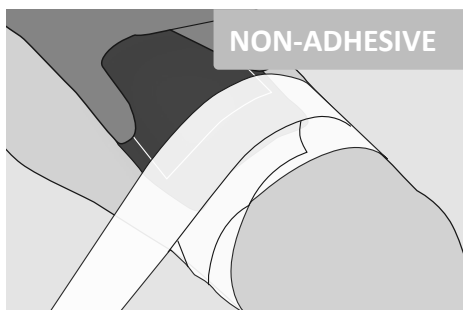

NON-ADHESIVE

Fix the dressing in place with an appropriate non traumatic retention product, e.g. Medicrope® Crepe bandage.

DRESSING CHANGE

The clinician-in-charge is responsible for determining the need for dressing changes, dependent on the stage and phase of wound healing and exudate level.

The dressing should be changed when exudate absorption is considered to be extending beyond the wound surface area.

7 days is the maximum period between dressing changes.