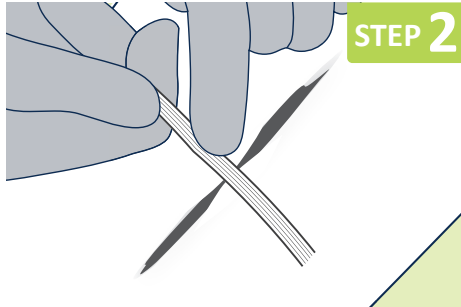
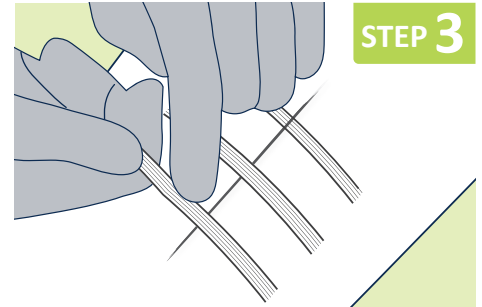
**STEP 1**

Cleanse wound thoroughly, using local protocols. The skin surrounding the wound should be clean and dry.

**STEP 2**

At midpoint of the incision press one half of the first strip firmly into place up to the wound margin. Using fingers or forceps bring together wound edges. Press remaining half of strip firmly into place.

**STEP 3**

In large wounds, apply additional strips at intervals, in the same manner. Complete wound closure with strips spaced slightly apart to allow for drainage.

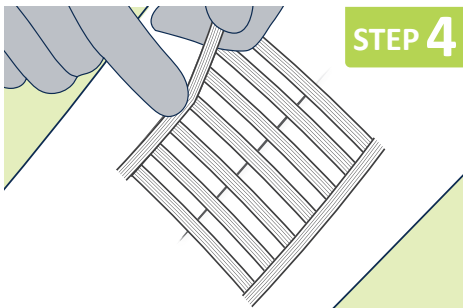
**STEP 4**

If required in larger wounds, apply an additional strip parallel to the wound edge, at either side of the closure.

INDICATIONS

AsGUARD® SurgiStrip® Reinforced Skin Closures are intended for use as a wound closure device for superficial wounds, lacerations and surgical incisions. May also be used in conjunction with staples and sutures and for support of wounds, post suture removal.

DRESSING CHANGE

To minimise potential damage at the wound site, carefully pull the end of the strip to the centre of the wound. Repeat for the other side and gently lift off the wound. An adhesive remover wipe can be used to ease the dressing edges away.

CONTRAINDICATIONS

Should not be used if allergies to any of its components, is known.
Should not be used on infected wounds.
Do not apply under tension.